

Cut your own trim - stripes, checks, sunbursts, insignia, letters

# Solartrim

Made in England by Solarfilm  
For details of all Solarfilm products  
visit [www.Solarfilm.co.uk](http://www.Solarfilm.co.uk)

ultra-thin, self adhesive colour trim sheet for use on smooth, glossy surfaces.

- ◆ Cut out, peel off and press-on – no heat needed.
- ◆ Thin as a coat of paint – no bubbles.
- ◆ Fuel resistant – with extra strong grip.

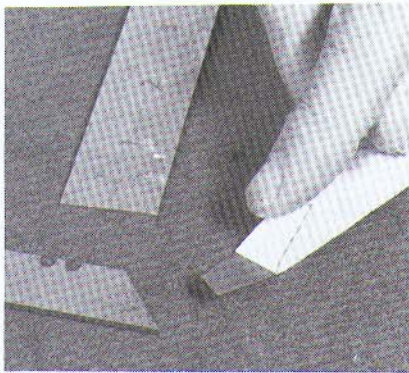

1

● **SURFACE PREPARATION.** Clean the surface free of dust or grease. Surface must be smooth or glossy for the best results.

● **APPLICATION.** Cut the Solartrim to shape. Peel back the paper liner from the first half inch and fold the end of the liner back on to itself – see photo 1. Carefully place the Solartrim exactly in position and rub down the prepared end so it sticks to the surface. Grip the folded end of the liner and slowly pull it back under the Solartrim, rubbing the Solartrim down firmly as you go – see photo 2. Continue until the whole of the Solartrim is attached.

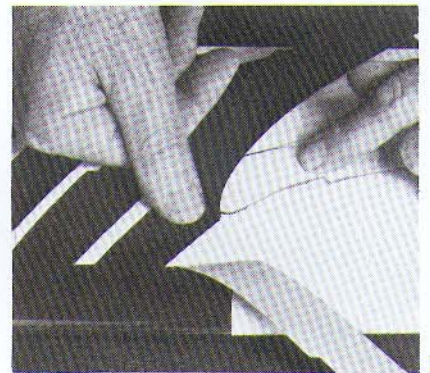

2

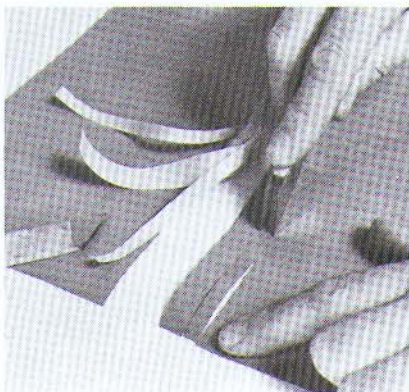

3

● **STRIPES** – Cut with a 'twin' blade (two blades, one taped each side of a balsa or ply spacer – the thickness of the spacer controls the width of stripe). See photo 3.

● **SUNBURST** – Use a basic triangle shape cut from card to mark out triangles on the back of Solartrim. Cut out the Solartrim triangles with a blade and straightedge. Use the card triangle to mark the position of the sunburst on the model surface – the 'space' between the triangles is usually the same size as the triangles. Press on the Solartrim triangles, starting from the 'point' and working along to the wide end.

● **CHECKS** – Draw squares on the paper backing of the Solartrim. Cut into strips and then squares with a blade and straightedge. Use a pencil line or strip of masking tape on the surface to keep the first row of checks straight – see photo 4.

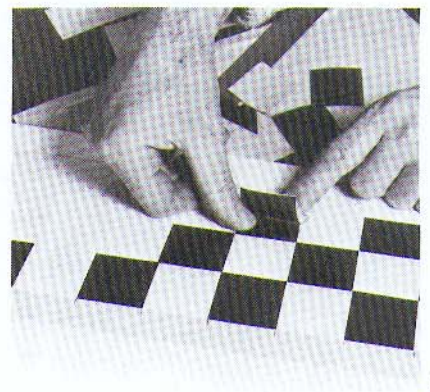

4

● **COMPLEX DESIGNS** – Draw round the part (wing, fuselage, etc.) on to plain paper (decorators 'lining' paper) and then draw the design inside the outline of the part. Cut out the design shapes from the paper and save the 'mask' left after cutting out the shapes. Tape the paper shapes on to the back of Solartrim and draw round the shapes. Cut out the Solartrim to the drawn outlines. (Note: if left and right hand versions of the same design are needed eg. for left and right fuselage sides, then tape two pieces of Solartrim face to face before cutting out). Use the 'mask' to mark reference points of the design on to the wing or fuselage, using a grease pencil. Apply the Solartrim shapes using the reference points to get the correct alignment of the shapes.

● **INSIGNIA AND LETTERING** – Add a few drops of 'washing-up liquid' to a large bowl of water. Cut out the Solartrim shapes and immerse them in the water. Peel off the paper backing under the water. Wet the surface of the model and lay the wet trim in place, sliding it about until it is in exactly the correct place. Then squeegee the water out from under the trim with a pad of tissue. Multi colour insignia can be assembled on the base colour and then 'floated' on the model as a single piece e.g. a roundel is prepared on a circle of blue, by floating on a white circle and a red circle while the blue is still flat on the paper backing. The complete roundel is then peeled off in water and floated on to the model. If a matt finish is required, rewet the Solartrim and rub gently with fine wire wool or abrasive cleaning powder (Aiax).

● **DOUBLE CURVATURE** – Solartrim can be shrunk to conform to double curvature using heat from an iron.

# REMOVING WRINKLES FROM SOLARTRIM

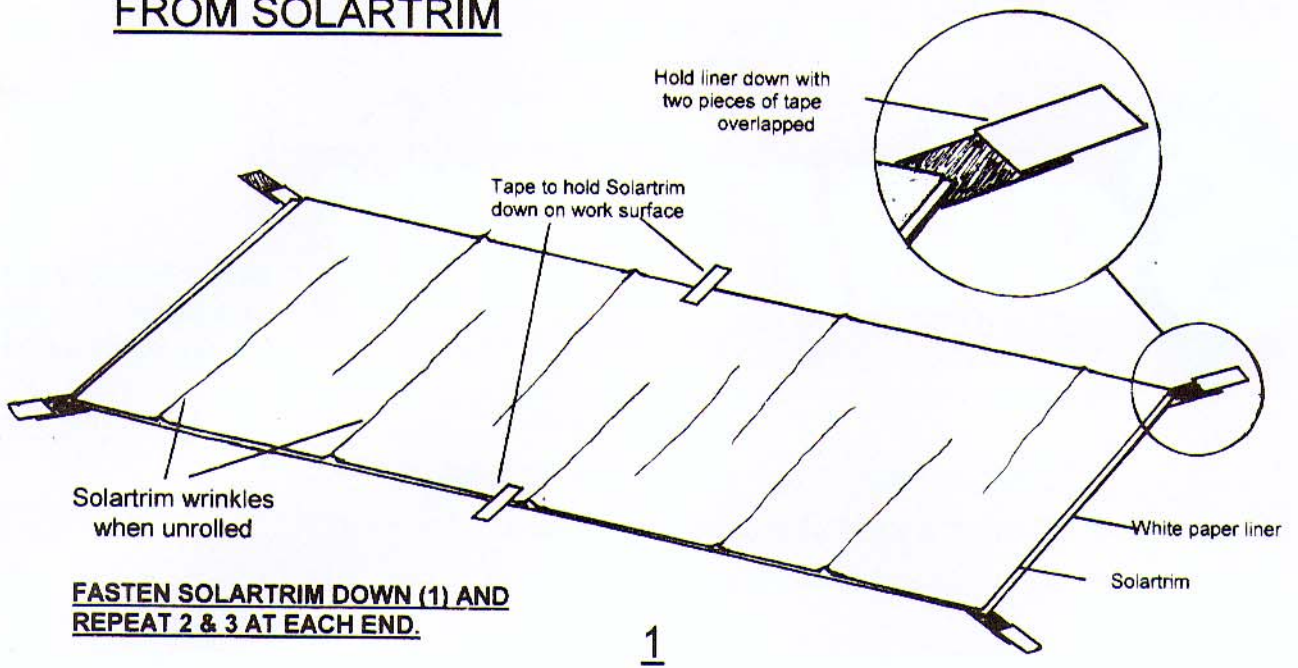

**FASTEN SOLARTRIM DOWN (1) AND REPEAT 2 & 3 AT EACH END.**

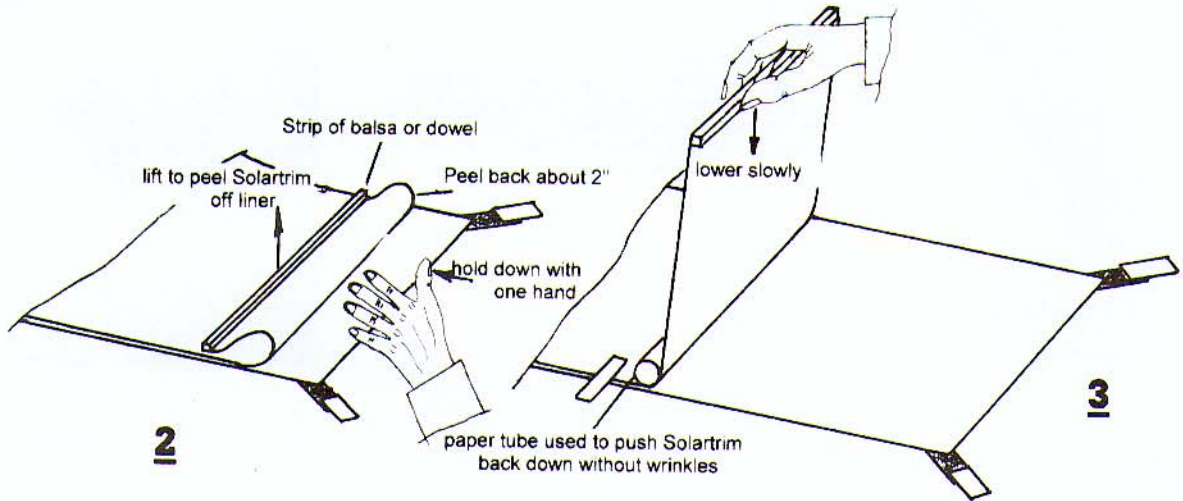

## CIRCLE CUTTER

Hold cutter in left hand and place spike at centre of a square of Solartrim. Do not move cutter - just pull Solartrim round under cutter with right hand until a complete circle has been cut by the blade.

